

**AC Fan Motors**

**San Ace** 120mm  
**San Ace**



AC Fan Motors

**Silent best-selling models**

**General specifications**

- Motor construction ..... Shaded pole motor
- Motor protection system ..... Impedance protection
- Dielectric strength ..... 50/60 Hz, 1500 VAC, 1 minute  
(between input terminal and frame)
- Operating voltage range ..... +10%
- Plug cord ..... For general 489-006 (L10,L21) /489-016 (L10,L21)  
For UL/CSA 489-007 (L10,L21)  
For UL/CSA 489-047 (L10,L21)

**25mm thick SAN ACE**

**Specifications** (Operating thermally range -30°C to +60°C)

Model	Voltage (V)	Frequency (Hz)	Input (W)	Current (A)	Bound current (A)	Rotating speed (min <sup>-1</sup> )	Air flow (m <sup>3</sup> /min) (CFM)	Static pressure (Pa)	Noise (dB[A])	Mass (g)					
<b>109S085</b>	100	50/60	13.5/12	0.16/0.14	0.19/0.17	2500/2900	1.92/2.22 67.8/78.4	49/53.9	38/41	370					
<b>109S084</b>	115			0.14/0.12	0.16/0.15										
<b>109S088</b>	200			0.08/0.07	0.1/0.09										
<b>109S087</b>	230			0.07/0.06	0.08/0.07										
☆ <b>109S081</b>	100			0.11	0.11/0.1										
☆ <b>109S083</b>	115			9.5/8.5	0.1						0.1/0.09	2200/2350	1.63/1.78 57.6/62.9	29.4/26.3	34/35
☆ <b>109S082</b>	200				0.07						0.07/0.06				
☆ <b>109S089</b>	230				0.06						0.06/0.05				
※ <b>109S086</b>	100			12/10	0.14/0.12						0.15/0.13	1400/1600	1.11/1.35 39.2/47.7	15.7/19.6	24/27

☆ represents half-speed. ※ represents low-speed.

**Typical air flow and static pressure characteristics**

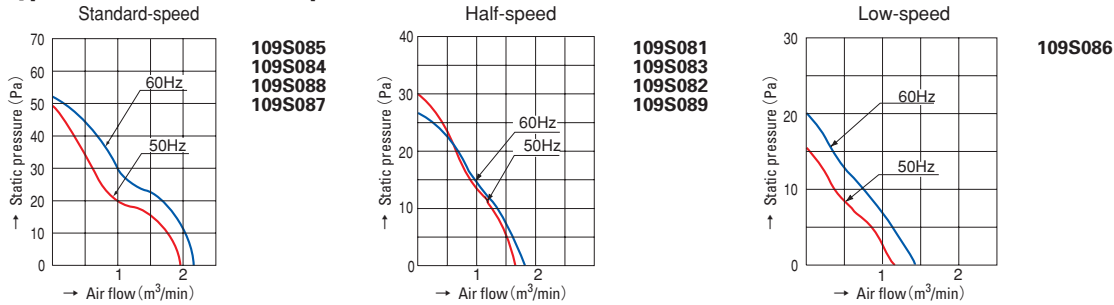

**38mm thick SAN ACE**

**Specifications** (Operating thermally range -30°C to +60°C)

Model	Voltage (V)	Frequency (Hz)	Input (W)	Current (A)	Bound current (A)	Rotating speed (min <sup>-1</sup> )	Air flow (m <sup>3</sup> /min) (CFM)	Static pressure (Pa)	Noise (dB[A])	Mass (g)
<b>109S005</b>	100	50/60	14/12	0.18/0.16	0.25/0.22	2700/3100	2.35/2.7 83/95.4	55.9/65.7	40/43	550
<b>109S005UL</b>	100			0.16/0.14	0.21/0.18					
<b>109S024</b>	120			0.16/0.14	0.21/0.18					
<b>109S024UL</b>	115			0.09/0.08	0.13/0.11					
<b>109S008</b>	200			0.09/0.08	0.13/0.11					
<b>109S008UL</b>	200			0.08/0.07	0.11/0.09					
<b>109S025</b>	230			0.08/0.07	0.11/0.09					
<b>109S025UL</b>	230			0.08/0.07	0.11/0.09					

**Typical air flow and static pressure characteristics**

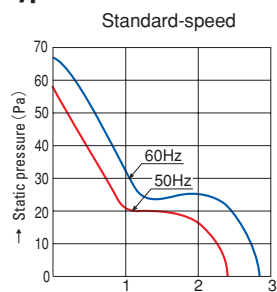

120mm

# 38mm thick SAN ACE

## Specifications

Model	Voltage (V)	Frequency (Hz)	Input (W)	Current (A)	Bound current (A)	Rotating speed (min <sup>-1</sup> )	Air flow (m <sup>3</sup> /min)	Air flow (CFM)	Static pressure (Pa)	Noise (dB[A])	Mass (g)
☆109S029UL	100	50/60	14/12	0.18/0.16	0.23/0.21	2450/2700	2.15/2.35	76/83	44.1/49.0	38/40	550
☆109S013			13/11	0.16/0.14	0.16/0.15	1800/2000	1.54/1.72	54.4/60.8	24/27	30/32	
☆109S013UL			7/7	0.1/0.09	0.1/0.09	1650/1700	1.45/1.5	51.2/53	17.6/17.6	28/28	
※109S006			7/7	0.1/0.09	0.1/0.09	1650/1700	1.45/1.5	51.2/53	17.6/17.6	28/28	
※109S006UL			10/10	0.13/0.11	0.13/0.11	1800/1900	1.56/1.64	55/57.9	20/20.6	30/31	
※109S010			7/7	0.05/0.04	0.05/0.04	1650/1700	1.45/1.5	51.2/53	17.6/17.6	28/28	
※109S010UL	200	50/60	7/7	0.05/0.04	0.05/0.04	1650/1700	1.45/1.5	51.2/53	17.6/17.6	28/28	
※109S010UL	240	50/60	11/11	0.06/0.05	0.06/0.05	1800/1950	1.58/1.68	55.8/59.3	20.6/21.6	30/32	

☆ represents half-speed. ※ represents low-speed.

## Typical air flow and static pressure characteristics

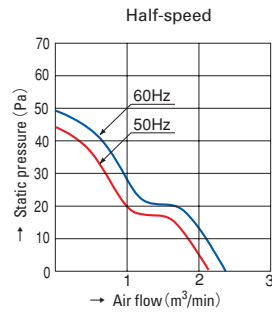

109S029UL

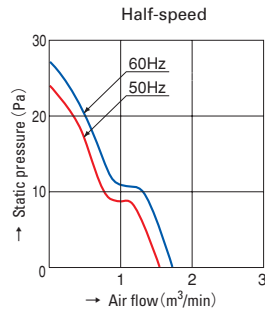

109S013  
109S013UL

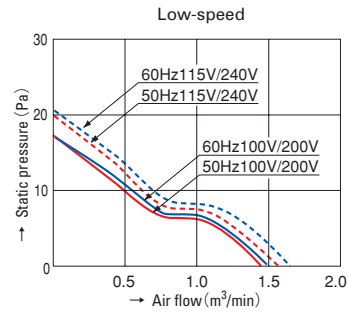

109S006  
109S006UL  
109S010  
109S010UL

# 38mm thick New SAN ACE

## Specifications

Model	Voltage (V)	Frequency (Hz)	Input (W)	Current (A)	Bound current (A)	Rotating speed (min <sup>-1</sup> )	Air flow (m <sup>3</sup> /min)	Air flow (CFM)	Static pressure (Pa)	Noise (dB[A])	Mass (g)
109S075UL	100	50/60	18/16	0.24/0.21	0.32/0.28	2700/3100	2.5/2.9	88.3/102.5	57.9/68.7	42/45	550
109S074UL	115			0.21/0.18	0.27/0.24						
109S078UL	200			0.12/0.1	0.16/0.14						
109S072UL	230			0.11/0.09	0.14/0.13						

## Typical air flow and static pressure characteristics

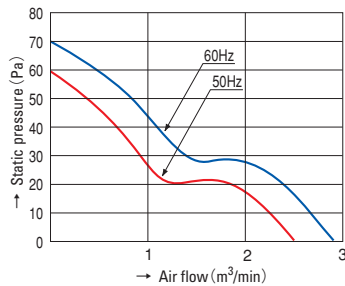

109S075UL 109S074UL  
109S078UL 109S072UL

## Dimensions (unit : mm)

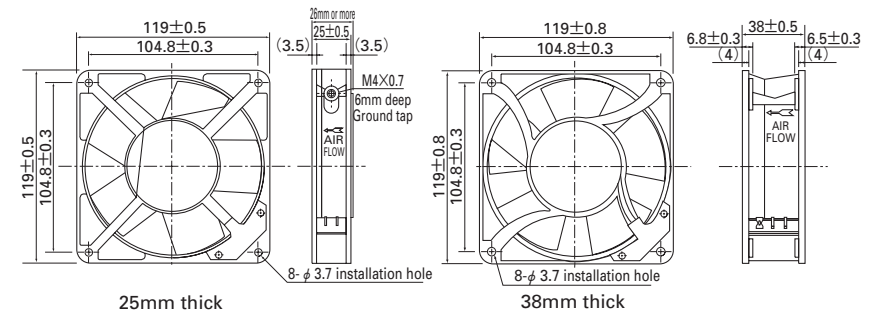

## Reference dimensional diagram for installation holes (unit : mm)

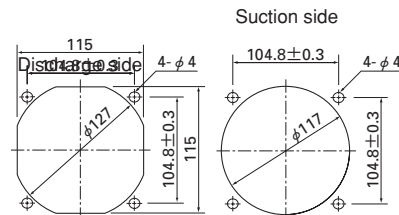

## Wiring diagram

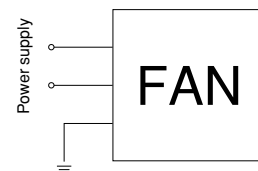

## Notice

- The products shown in the catalog are subject to Japanese Export Control Law. Diversion contrary to the law of exporting country is prohibited.
- To protect against electrolytic cooling corrosion that may occur in locations of strong electromagnetic noise, we provide fans that are unaffected by electrolytic corrosion. Alternative measures to protect against electrolytic corrosion may include metallic finger guards or other metallic attachments. Please contact us for details.